

BACHELOR OF ARCHITECTURE (B.Arch.)

Term-End Examination

June, 2017

00454

BARE-075 : INTERIOR DESIGN (ELECTIVE – 1)

Time : 3 hours

Maximum Marks : 70

Note : *Question no. 1 is compulsory. Answer any four questions from the rest. All questions carry equal marks. Illustrate with sketches. Question no. 7 should be done in A3 sheet provided. Assume suitable scale.*

1. Write short notes on any **four** of the following : $4 \times 3 \frac{1}{2} = 14$
- (a) Scale and Proportion
 - (b) Symmetry in Design
 - (c) Focal Point
 - (d) Ergonomics
 - (e) Frequency of Sound

2. (a) What are the different principles of design ? 4
- (b) How will you achieve balance in a design ?
Explain with sketches. 10
3. (a) What are the important anthropometrical considerations that have to be taken care of while designing a kitchen in a residence ? 4
- (b) Explain at least four with sketches. 10
4. (a) What are the various design styles in furniture ? 4
- (b) Explain with sketches, two classical chair designs that you know. 10
5. (a) What is barrier-free design ? 4
- (b) Explain the different ways by which you can make a space barrier-free. 10
6. Explain an HVAC system. Explain how the various components of an HVAC system affect the space design. Give your answer with reference to an office building. 14

7. Design a mural for a hospital lobby wall of size 20 m × 6 m. Use appropriate scale. Wall elevation is given below :

14

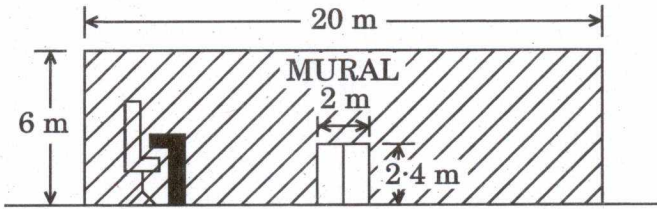

Elevation A

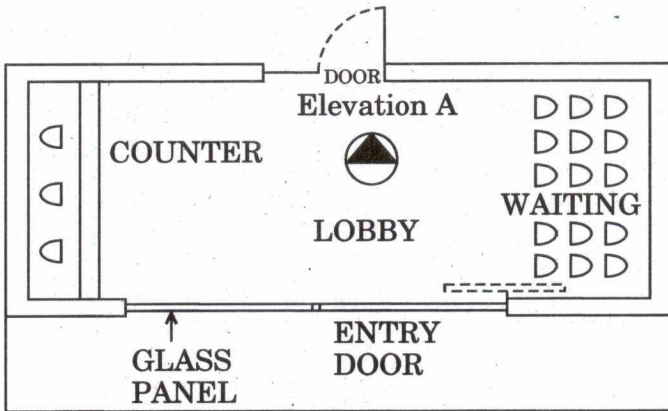

LOBBY PLAN